



Filtering time entries

Last updated - Feb 27, 2024 at 3:10PM

Web:	https://timedock.com
Email:	info@timedock.com
International:	(+64) 9 444 1384
Local phone:	(09) 444 1384

To search and filter through a list of clock entries, first log in to your TimeDock web portal and click on ***View recent In/Outs*** on the left-hand menu of the home screen.

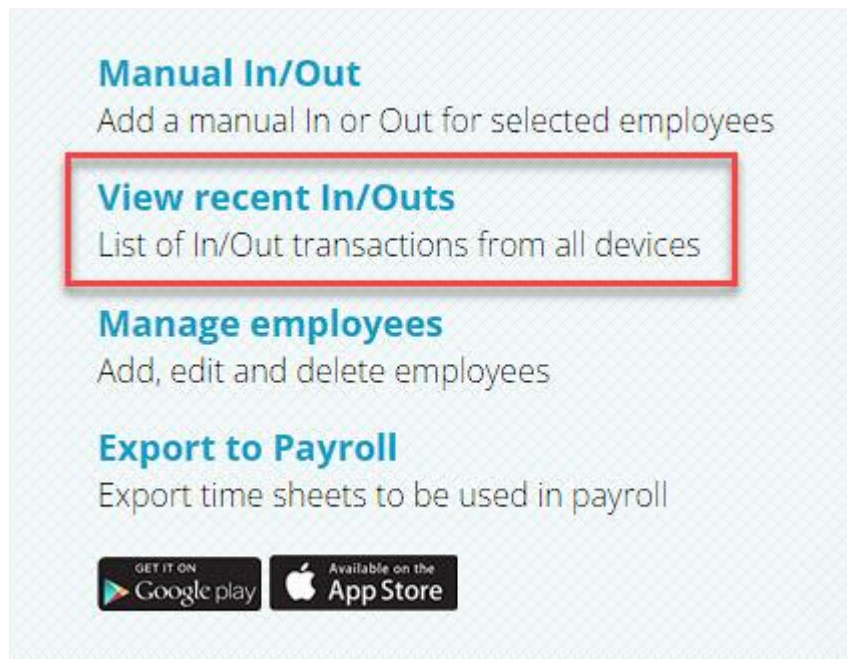

By default, this screen will list the top most recent 500 time entries for your entire TimeDock account. To filter and search for specific entries, click on ***Filters*** in the left-hand menu. In the pop-up that appears, click the green ***Add Filter*** button to view a list of available filters to apply.

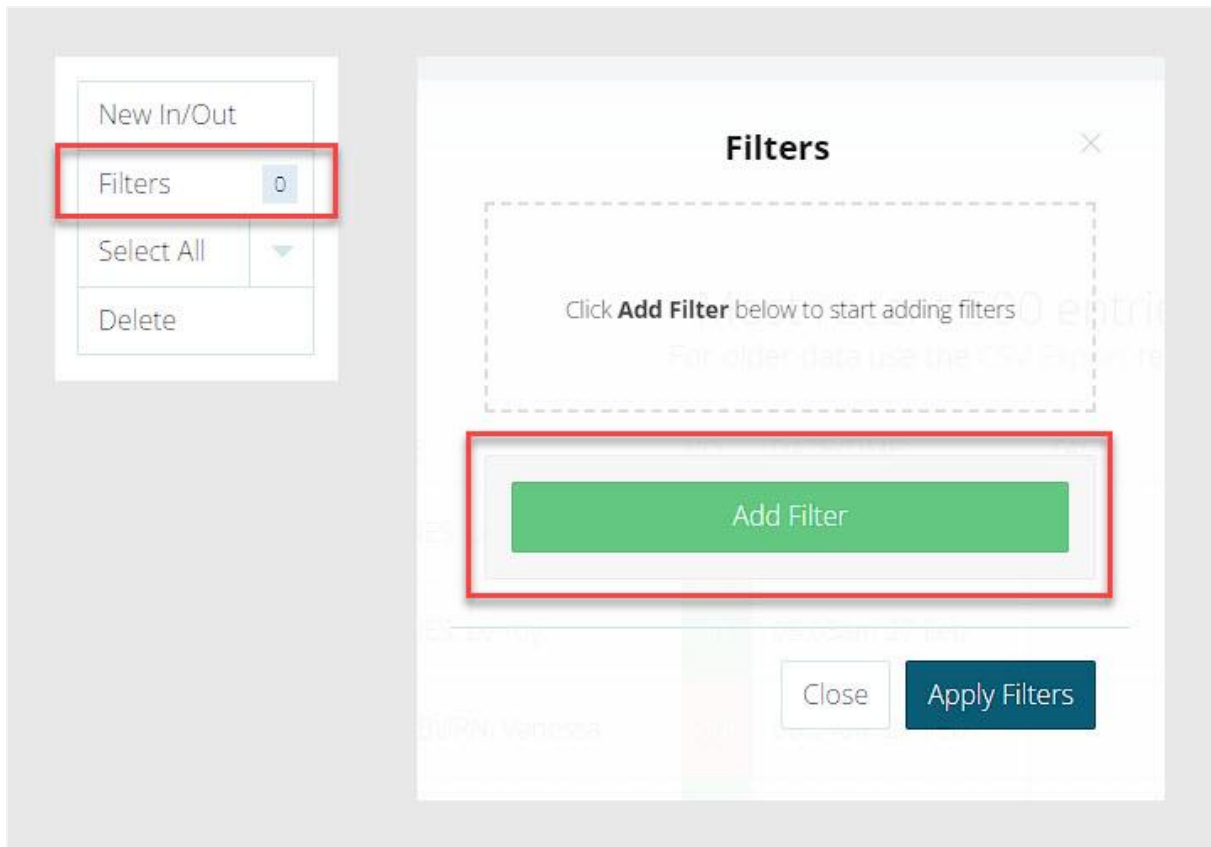

Click on a filter type to add it to your list of selected filters, then enter a filter value (or multiple values if applicable). Repeat for any additional filters you'd like, and when ready to apply, click the **Apply Filters** button in the bottom right-hand corner of the pop-up.

In the example below, we have chosen to filter the time entries to show all employees who have clocked *in* to the *Parnell* project between *6am and 8am* within any date range.

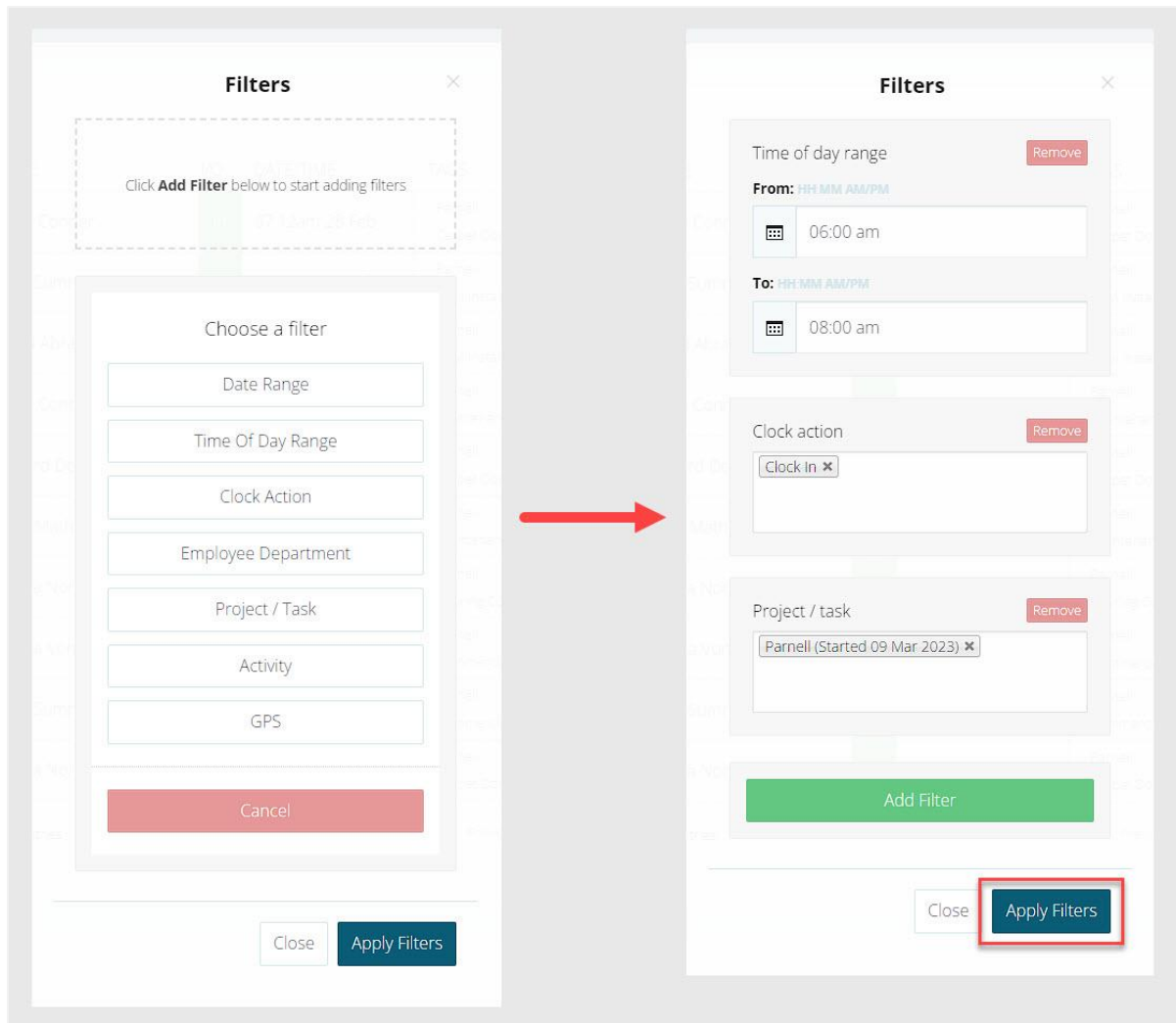







The filtered time entries will be listed on screen. The **Filters** option in the left-hand menu will display the number of applied filters next to it, and you can click on this button to add, change, or remove any of your filters.

New In/Out

Filters 3

Select All

Delete

.....	NAME	I/O	DATE/TIME	TAGS	GPS
	Steve Conner	in	07:12am 28 Feb	Parnell Carpet Domestic	-	EDIT
	Lana Sumner	in	06:54am 28 Feb	Parnell Vinyl Installation	-	EDIT
	Jerald Abram	in	06:46am 28 Feb	Parnell Vinyl Installation	-	EDIT
	Steve Conner	in	07:14am 27 Feb	Parnell Maintenance	-	EDIT
	Richard Devereux	in	06:55am 27 Feb	Parnell Carpet Domestic	-	EDIT
	Dave Mathieson	in	06:57am 26 Feb	Parnell Maintenance	-	EDIT
	Briana Normans	in	07:11am 25 Feb	Parnell Pouring Concrete	-	EDIT